

Specifications:  
 Current Rating:2.0A AC/DC  
 Voltage Rating:250V AC/DC  
 Contact Resistance:20m ohm. Max.  
 Insulation Resistance:1,000M ohm. Min.  
 Withstanding Voltage:AC 500V AC/minute  
 Operating Temperature Range:-40°C ~ +105°C  
 Material and Finish  
 Insulator:High Temp. Plastic (Nylon 9T UL94V-0)  
 Insulator Color:Ivory  
 Contact:Brass  
 Plating:Tin Plated  
 How To Order:  
 WF2RSM125-XXT-PN

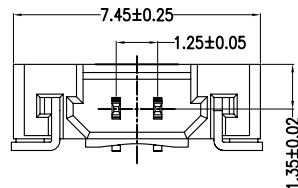

2Pin

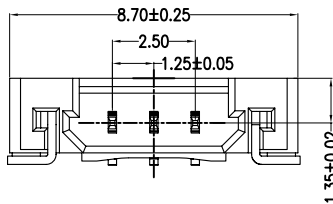

3Pin

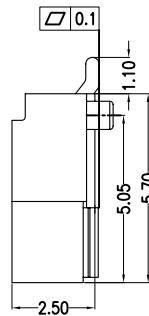
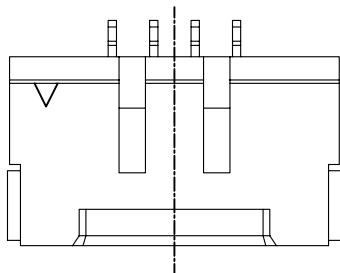

Dimension:(4~30P)

Pos	Dimension:		Pos	Dimension:	
	A	B		A	B
04	3.75	9.95	12	13.75	19.95
05	5.00	11.20	13	15.00	21.20
06	6.25	12.45	14	16.25	22.45
07	7.50	13.70	15	17.50	23.70
08	8.75	14.95	20	23.75	29.95
09	10.00	16.20	25	30.00	36.20
10	11.25	17.45	30	36.25	42.45
11	12.50	18.70			

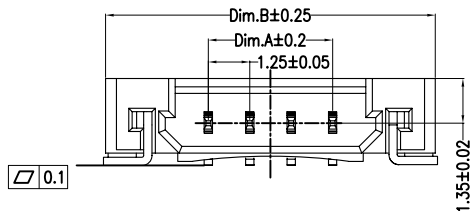

4~30Pin

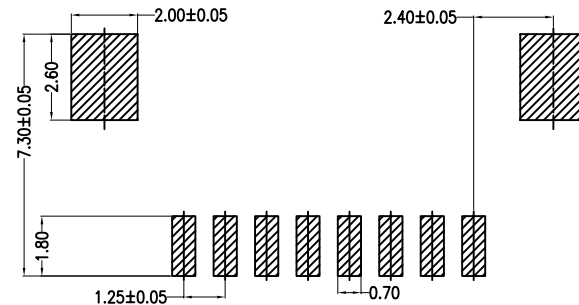

PCB LAYOUT

RoHS Compliant

F				DRAWN:	GENERAL TOLERANCE:	<b>HOYATO</b> 东莞好亚通电子厂 DESCRIPTION: 1.25mm Wafer Straight SMT Type PART NO: WF2RSM125-XXT-PN	SIZE <b>A4</b>
E			Ken	.X=±0.20 .XX=±0.15			
D			CHECKED:	UNIT: MM			
C			Lily Chou	SCALE: 1:1			
B			APPROVAL:	SHEET: 1 / 1			
A	01-SEP-2009	(H0043)	Ken	Chao Peng	PROJECTION:		
REV	DATE	FILE	BY				