

Specifications:
 Current Rating:6.5A AC,DC
 Voltage Rating:250V AC,DC
 Contact Resistance:10mohm Max
 Insulation Resistance:1000Mohm Min.
 Withstanding Voltage:1500V AC/minute
 Operating Temperature Range:-40°C~+105°C
 Material And Finish:
 Insulator:High Temp. Plastic(LCP UL94V-0)
 Insulator Color:Black
 Contact:Brass
 Plating:Tin Plated

How To Order
 WFV25-XXX-X-LK-XX

- BK:Black
- WH:White
- LK:With Lock
- A:A Key(only Black)
- B:B Key(Only White)
- G:Gold Plated
- T:Tin Plated
- No. Of Positions
- V:Straight Dip Type

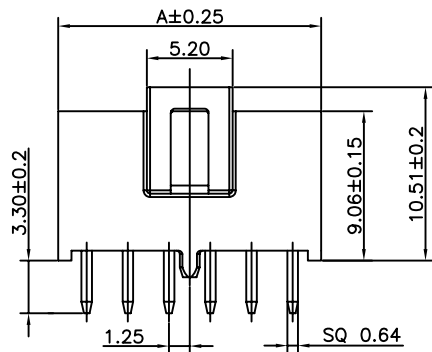

Even Positions
 04P,08P,12P,16P

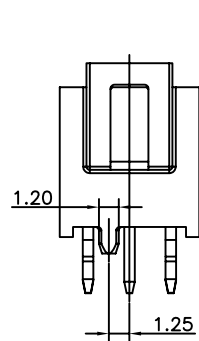

Odd Positions
 06P,10P,14P

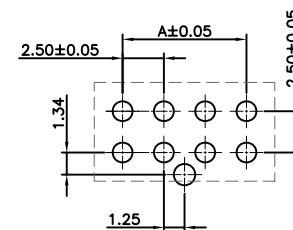
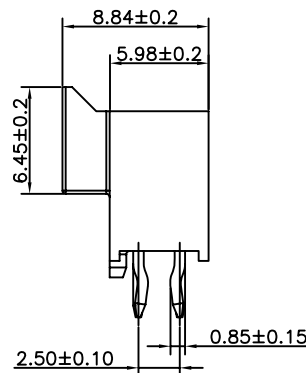

Even Positions
 04P,08P,12P,16P

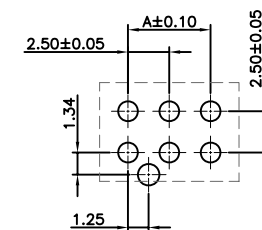

Odd Positions
 06P,10P,14P

RECOMMENDED PCB(Connector Side View)
 THICKNESS=1.6 To 2.4mm

Circuits	Dimension		Circuits	Dimension	
	A	B		A	B
4	5.95	2.5	12	15.95	12.50
6	8.45	5.0	14	18.45	15.00
8	10.95	7.5	16	20.95	17.50
10	13.45	10.0	18	23.45	20.00

RoHS Compliant

F				DRAWN: Ken	GENERAL TOLERANCE: .X=±0.20 .XX=±0.15		DESCRIPTION: 2.5mm Wafer Double Row Dip With Lock Type	SIZE A4
E								
D				APPROVAL: Chao Peng	SCALE: 1:1	PART NO: WFV25-XXX-X-LK-XX		
C					APPROVAL: Chao Peng			SHEET: 1 / 2
B				APPROVAL: Chao Peng		PROJECTION:		
A	05-Mar-2018	(PC0001)	Ken					
REV	DATE	FILE	BY					

1

2

3

4

5

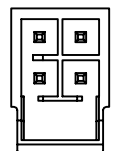

04P
KEY A

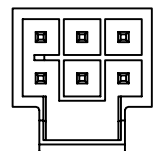

06P
KEY A

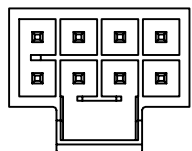

08P
KEY A

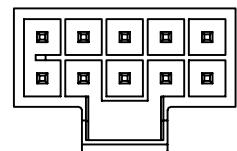

10P
KEY A

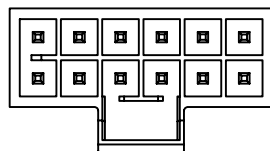

12P
KEY A

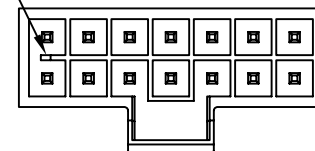

14P
KEY A

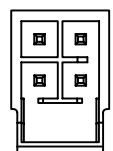
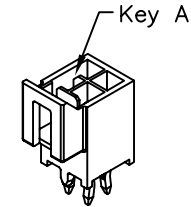

04P
KEY B

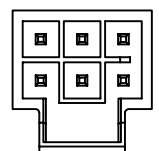

06P
KEY B

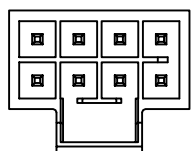

08P
KEY B

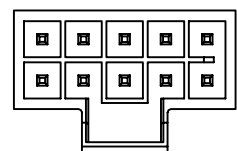

10P
KEY B

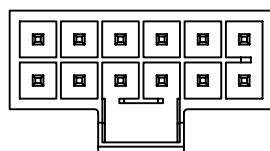

12P
KEY B

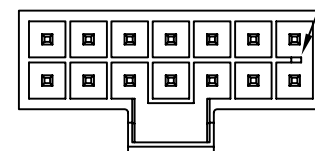

14P
KEY B

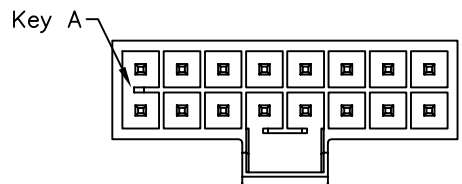
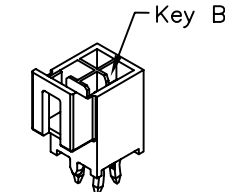

16P
KEY A

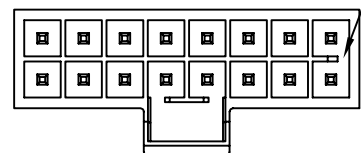

16P
KEY B

RoHS Compliant

F			
E			
D			
C			
B			
A	05-Mar-2018	(PC0001)	Ken
REV	DATE	FILE	BY

DRAWN:
Ken

CHECKED:
Lily Chou

APPROVAL:
Chao Peng

GENERAL TOLERANCE:
.X=±0.20
.XX=±0.15

UNIT: MM

SCALE: 1:1

SHEET: 2 / 2

PROJECTION:



DESCRIPTION:
2.5mm Wafer Double Row Dip With Lock Type

PART NO:
WFV25-XXX-X-LK-XX

SIZE
A4

A
B
C
D