

Specification:
 Current Rating:2.0A AC/DC
 Voltage Rating:125V AC/DC
 Contact Resistance:20mohm max.
 Insulation Resistance:1000Mohm min.
 Withstand Voltage:500V AC/Minute
 Operating Temperature Range:-40°C to +85°C
 Material and Finish:
 Material:High Temp. Plastic (Nylon 66 UL94V-0)
 Insulator Color:Black
 Contact:Phosphor Bronze
 Plating:Tin Plated
 Wire Range:AWG #24~#28

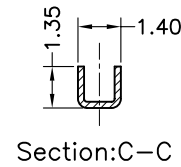

2026TG

How To Order:
 HA20-XX
 └──────────┬──────────
 Number of Circuits

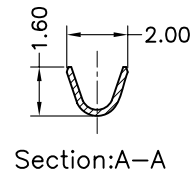
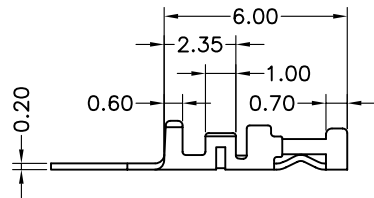
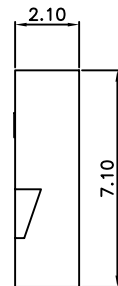
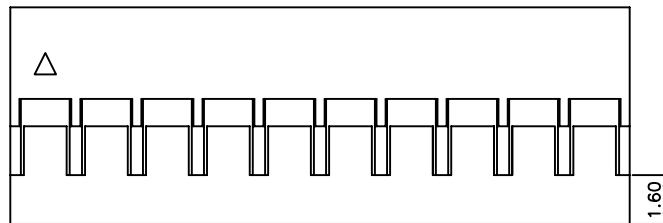
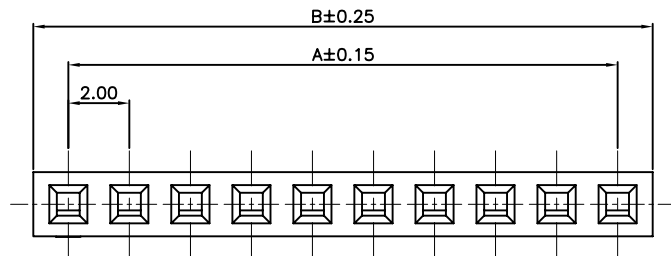

Dimension:

Circuits	Dimension		Circuits	Dimension		Circuits	Dimension	
	Dim.A	Dim.B		Dim.A	Dim.B		Dim.A	Dim.B
2	2.00	4.30	15	28.00	30.30	28	54.00	56.30
3	4.00	6.30	16	30.00	32.30	29	56.00	58.30
4	6.00	8.30	17	32.00	34.30	30	58.00	60.30
5	8.00	10.30	18	34.00	36.30	31	60.00	62.30
6	10.00	12.30	19	36.00	38.30	32	62.00	64.30
7	12.00	14.30	20	38.00	40.30	33	64.00	66.30
8	14.00	16.30	21	40.00	42.30	34	66.00	68.30
9	16.00	18.30	22	42.00	44.30	35	68.00	70.30
10	18.00	20.30	23	44.00	46.30	36	70.00	72.30
11	20.00	22.30	24	46.00	48.30	37	72.00	74.30
12	22.00	24.30	25	48.00	50.30	38	74.00	76.30
13	24.00	26.30	26	50.00	52.30	39	76.00	78.30
14	26.00	28.30	27	52.00	54.30	40	78.00	80.30

RoHS Compliant

F				DRAWN: Ken	GENERAL TOLERANCE: .X=±0.20 .XX=±0.15		DESCRIPTION: 2.0mm Housing & Terminal	SIZE A4
E								
D				APPROVAL: Chao Peng	SCALE: 1:1	PART NO: HA20-XX		
C					PROJECTION:			SHEET: 1 / 1
B								
A	01-SEP-2017	(PC0001)	Ken					
REV	DATE	FILE	BY					