

Section:C-C

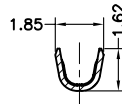

Section:B-B

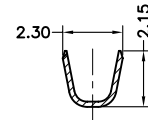

Section:A-A

HTM25T

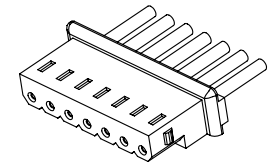
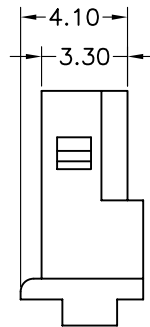
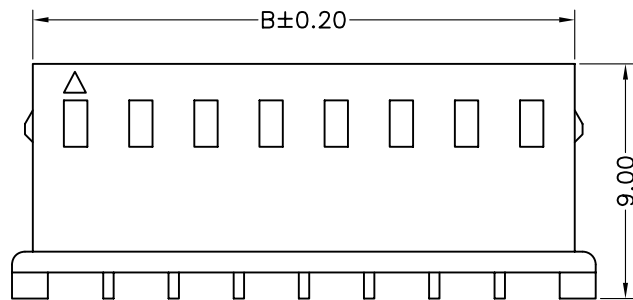
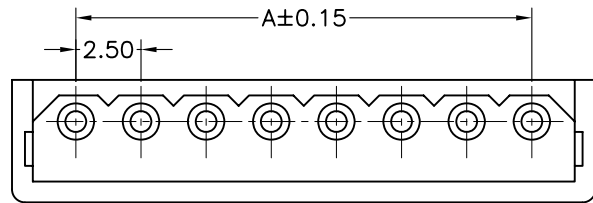

Specifications:  
 Current Rating:3.0A AC,DC  
 Voltage Rating:250V AC,DC  
 Contact Resistance:20mΩmax  
 Insulation Resistance:1000MΩmin  
 Withstanding Voltage:1000V AC/minute  
 Temperature Range: -40°C to +85°C  
 Application Wire: Awg#22~#30  
 Material:  
 Insulator:Nylon 66 (UL94V-0)  
 Insulator Color:Beige  
 Contact:Phosphor Bronze  
 Plated;Tin Plated  
 How To Order:  
 HM25-XX

No.of Contact

Dimension:

Circuits	DIM.A	DIM.B	Circuits	DIM.A	DIM.B
2	2.50	5.80	9	20.00	23.30
3	5.00	8.30	10	22.50	25.80
4	7.50	10.80	11	25.00	28.30
5	10.00	13.30	12	27.50	30.80
6	12.50	15.80	13	30.00	33.30
7	15.00	18.30	14	32.50	35.80
8	17.50	20.80	15	35.00	38.30

RoHS Compliant

F				DRAWN: Ken	GENERAL TOLERANCE: .X=±0.20 .XX=±0.15		DESCRIPTION: 2.5mm Female Housing & Terminal	SIZE <b>A4</b>
E				CHECKED: Lily Chou				
D				APPROVAL: Chao Peng	SCALE: 1:1	PART NO: HM25-XX & HTM25T		
C					SHEET: 1 / 1			
B				DATE	FILE	BY		
A	12-SEP-2009	(PC0001)	Ken					
REV								

