

HRT25T(PC0026)

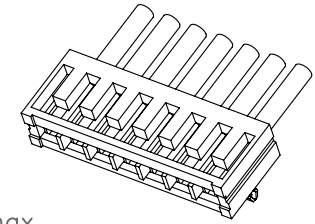
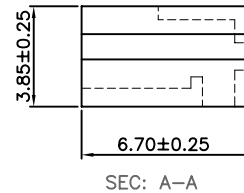
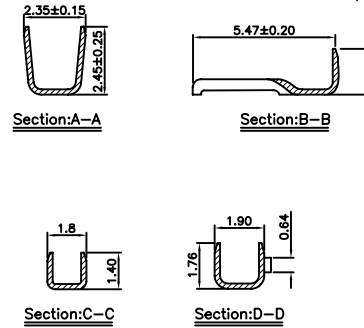
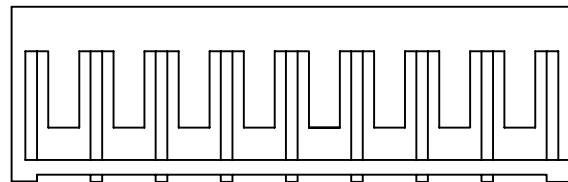
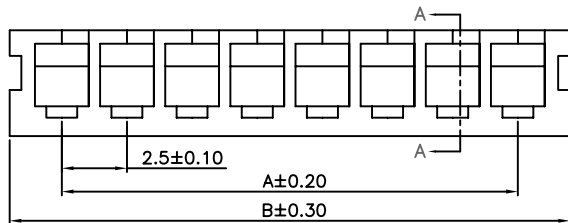

Specifications:
 Current Rating:3.0A AC,DC
 Voltage Rating:250V AC,DC
 Contact Resistance:20mΩmax
 Insulation Resistance:1000MΩmin
 Withstanding Voltage:1000V AC/minute
 Temperature Range: -40°C to +85°C
 Application Wire: Awg#22~#30
 Material:
 Insulator:Nylon 66 (UL94V-0)
 Insulator Color:White
 Contact:Brass
 Plated;Tin Plated
 How To Order:
 HR25-XX

No. of Contact

Dimension:

Circuits	Dim.A	Dim.B	Circuits	Dim.A	Dim.B
2	2.50	6.50	10	22.50	26.50
3	5.00	9.00	11	25.00	29.00
4	7.50	11.50	12	27.50	31.50
5	10.00	14.00	13	30.00	34.00
6	12.50	16.50	14	32.50	36.50
7	15.00	19.00	15	35.50	39.00
8	17.50	21.50	16	37.50	41.50
9	20.00	24.00			

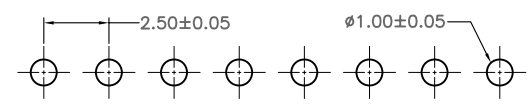

PCB LAYOUT

RoHS Compliant

F				DRAWN: Ken	GENERAL TOLERANCE: .X=±0.20 .XX=±0.15		DESCRIPTION: 2.5mm Borad-in Wire R/A Housing & Terminal	SIZE A4
E				CHECKED: Lily Chou	UNIT: MM			
D				APPROVAL: Chao Peng	SCALE: 1:1	PART NO: HR25-XX & HRT25T		
C					SHEET: 1 / 1			
B					PROJECTION:			
A	01-SEP-2015	(PC0001)	Ken					
REV	DATE	FILE	BY					