

Section:A-A

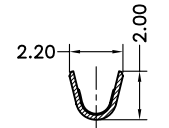

Section:B-B

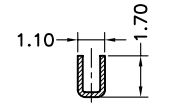

Section:C-C

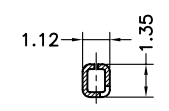

Section:D-D

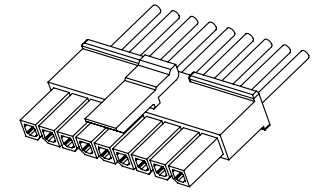

Specifications:  
 Current Rating:5.0A AC/DC  
 Voltage Rating:250V AC/DC  
 Contact Resistance:10m ohm. Max.  
 Insulation Resistance:1000M ohm. Min.  
 Withstanding Voltage:1.500V AC/Minute  
 Operating Temperature Range:-40°C~+85°C  
 Material and Finish  
 Insulator:Nylon66 UL94V-0  
 Insulator Color: Black  
 Contact:Phosphor Bronze  
 Plating:Tin Plated  
 Mating With:HST30T terminal  
 How To Order  
 HSA30-XX

— No. Of Positions

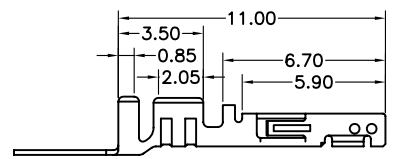

HST30T

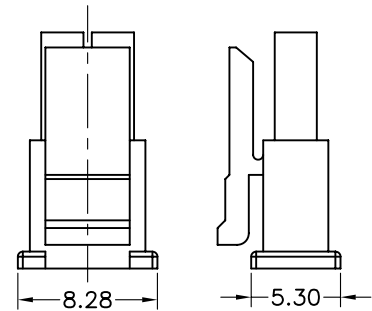
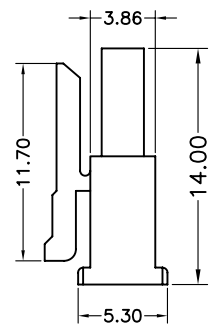
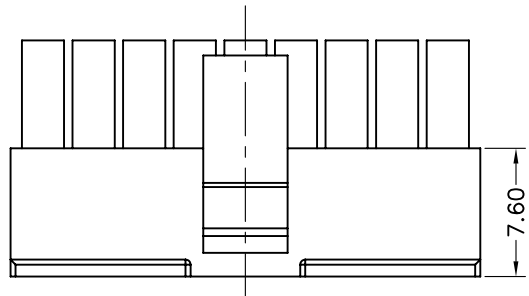
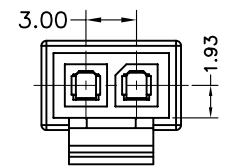
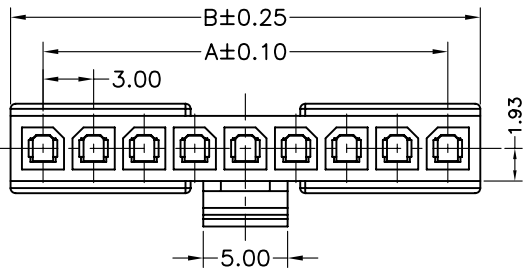

(2PIN Circuit Housing)

Dimension:

Circuits	Dim.A	Dim.B	Circuits	Dim.A	Dim.B
2	3.00	See detail	8	21.00	24.85
3	6.00	9.85	9	24.00	27.85
4	9.00	12.85	10	27.00	30.85
5	12.00	15.85	11	30.00	33.85
6	15.00	18.85	12	33.00	36.85
7	18.00	21.85			

RoHS Compliant

F			
E			
D			
C			
B			
A	01-SEP-2012	(PC0001)	Ken
REV	DATE	FILE	BY

DRAWN: Ken	GENERAL TOLERANCE: .X=±0.20 .XX=±0.15
CHECKED: Lily Chou	UNIT: MM
APPROVAL: Chao Peng	SCALE: 1:1
	SHEET: 1 / 2
	PROJECTION:



DESCRIPTION: 3.0mm Power Socket Single Row Housing & Terminal	SIZE <b>A4</b>
PART NO: HSA30-XX & HST30T	

1

2

3

4

5

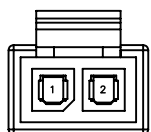

2PIN

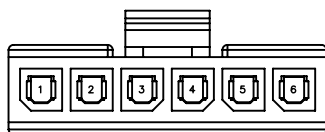

6PIN

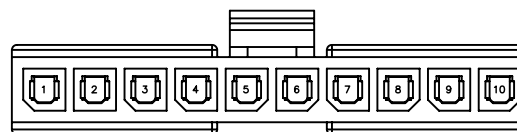

10PIN

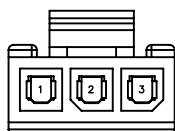

3PIN

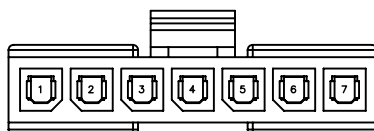

7PIN

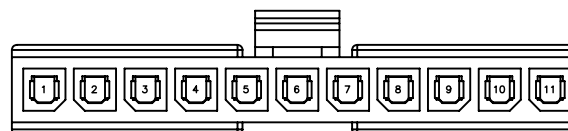

11PIN

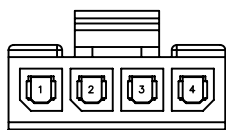

4PIN

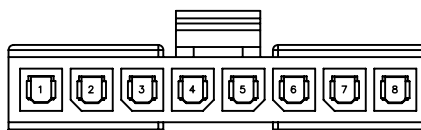

8PIN

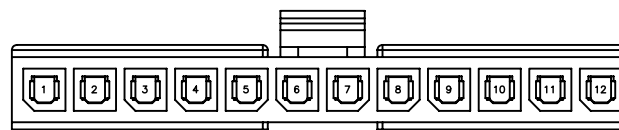

12PIN

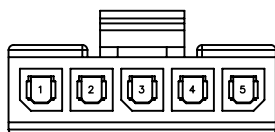

5PIN

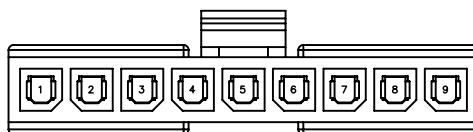

9PIN

2~12P Protection Key Drawing(Ref.)

RoHS Compliant

F				DRAWN:	GENERAL TOLERANCE:		DESCRIPTION:	SIZE
E				Ken	.X=±0.20 .XX=±0.15			
D				CHECKED:	UNIT: MM	3.0mm Power Socket Single Row Housing & Terminal	PART NO:	A4
C				Lily Chou	SCALE: 1:1			
B				APPROVAL:	SHEET: 2 / 2	HSA30-XX & HST30T		
A	01-SEP-2012	(PC0001)	Ken	Chao Peng	PROJECTION:			
REV	DATE	FILE	BY					