

1

2

3

4

5

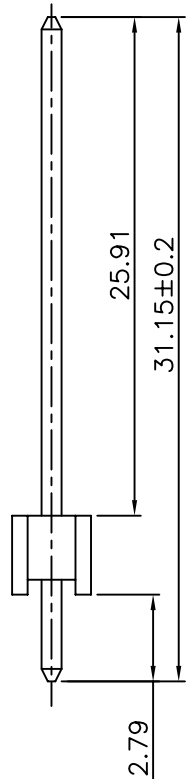
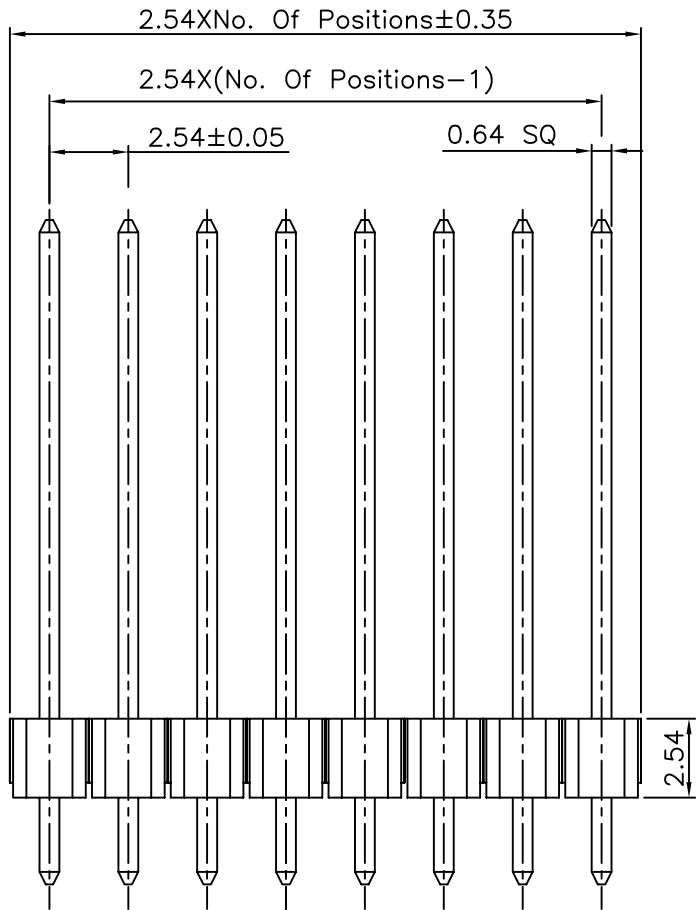
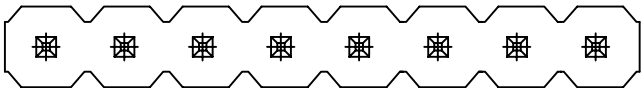

Specifications

Current Rating:3.0A AC/DC
 Voltage Rating:250V AC/DC
 Contact Resistance:20m ohm. Max.
 Insulation Resistance:1,000M ohm. Min.
 Withstanding Voltage:600V AC For One Minute
 Operating Temperature Range:-40°C To +105°C
 Material and Plated
 Insulator:High Temp. Plastic(PBT UL94V-0)
 Insulator Color:Black
 Contact:Copper Alloy
 Plated:Gold Plated
 How To Order
 PHV254-XXX-3110

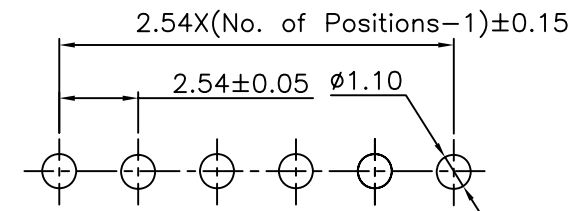
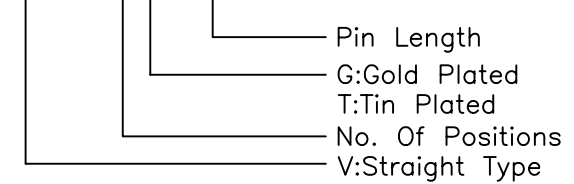

PCB Layout

RoHS Compliant

F				DRAWN: Ken
E				
D				CHECKED: Lily Chou
C				
B				APPROVAL: Chao Peng
A	16-Nov-2020	(PC0001)	Ken	
REV	DATE	FILE	BY	

GENERAL TOLERANCE: .X=±0.20 .XX=±0.15
UNIT: MM
SCALE: 1:1
SHEET: 1 / 1
PROJECTION:

	DESCRIPTION: 2.54mm Pin Header Single Row Straight Type
	PART NO: PHV254-XXX-3110

SIZE A4

A
B
C
D