

B1 Type

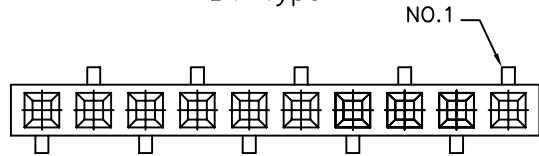

B2 Type

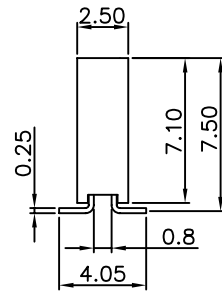

Specifications:

Current Rating: 3.0A AC/DC
 Voltage Rating: 250V AC/DC
 Contact Resistance: 20m ohm. max.
 Insulation Resistance: 1,000M ohm. min.
 Withstanding Voltage: 600V AC/minute
 Operating Temperature Range: -40°C to +105°C
 Material and Finish
 Insulator: High Temp. Plastic (Nylon 9T UL94V-0)
 Insulator Color: Black
 Contact: Phosphor Bronze
 Plating: Gold Plated
 How To Order
 PSSM254-XXG-75-BX

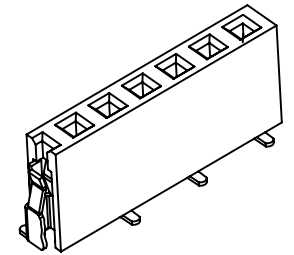

B1: B1 Type B2: B2 Type
 Total Height 7.5mm
 G: Gold Plated
 No. Of Positions
 SM: SMD Type

Dimension:

Poles	DIM:(mm)		Poles	DIM:(mm)	
	A	B		A	B
2	5.58	2.54	12	30.98	27.94
3	8.12	5.08	13	33.52	30.48
4	10.66	7.62	14	36.06	33.02
5	13.20	10.16	15	38.60	35.56
6	15.74	12.70	16	41.14	38.10
7	18.28	15.24	17	43.68	40.64
8	20.82	17.78	18	46.22	43.18
9	23.36	20.32	19	48.76	45.72
10	25.90	22.86	20	51.30	48.26
11	28.44	25.40			

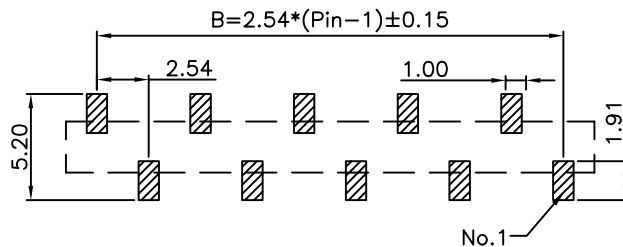

B1 Type

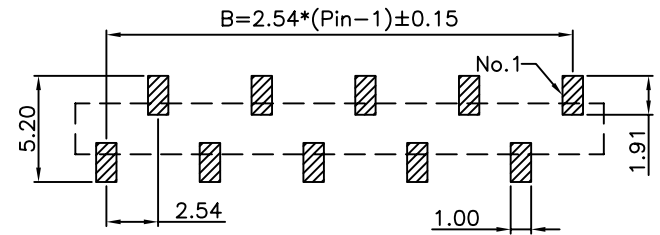

B2 Type

P.C.B. Layout

RoHS Compliant

F			
E			
D			
C			
B			
A	01-SEP-2009	(PC0001)	Ken
REV	DATE	FILE	BY

DRAWN:	Ken
CHECKED:	Lily Chou
APPROVAL:	Chao Peng
GENERAL TOLERANCE:	.X = ±0.20 .XX = ±0.15
UNIT:	MM
SCALE:	1:1
SHEET:	1 / 1
PROJECTION:	

DESCRIPTION:	2.54mm PCB Socket 7.5mm Height SMT Type
PART NO:	PSSM254-XXG-75

SIZE	A4
------	-----------