

1

2

3

4

5

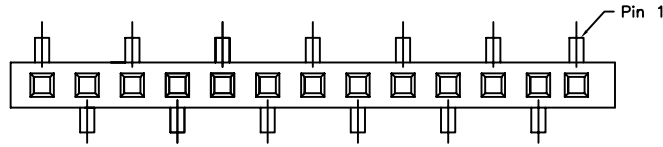

B2 Type

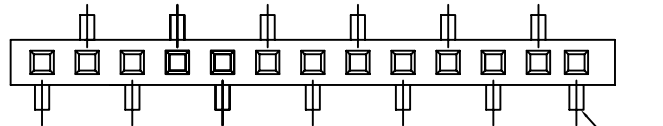

B1 Type

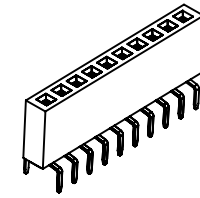
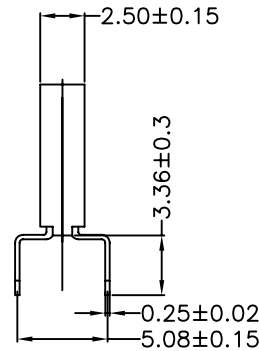
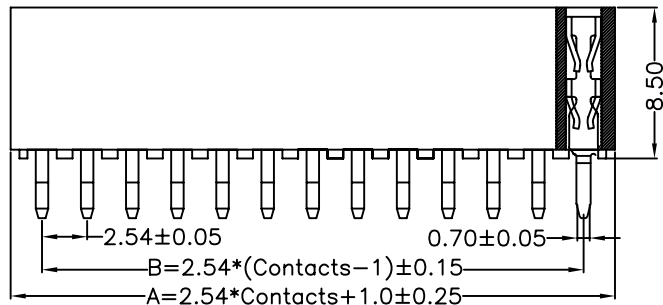

Specifications:

Current rating: 3.0A AC, DC  
 Voltage rating: 250V AC, DC  
 Contact resistance: 20m ohm max.  
 Insulation resistance: 1,000M ohm min.  
 Withstanding voltage: 600V AC/minute  
 Operating temperature range: -40°C to +105°C  
 Material:

Insulator: High Temp. Plastic (Nylon 6T UL94V-0)  
 Standard Color: Black  
 Contact: Phosphor Bronze  
 Finish: Gold Plated

How To Order

PSTB254-XXG-85-BX

- B1: B1 Type
- B2: B2 Type
- Plastic Height 8.5mm
- G: Gold Plated
- No. Of Contact
- TB: Bottom Entry

Dimension :

Contacts	DIM:(mm)		Contacts	DIM:(mm)		Contacts	DIM:(mm)		Contacts	DIM:(mm)	
	A	B		A	B		A	B		A	B
2	6.08	2.54	12	31.48	27.94	22	56.88	53.34	32	82.28	78.74
3	8.62	5.08	13	34.02	30.48	23	59.42	55.88	33	84.82	81.28
4	11.16	7.62	14	36.56	33.02	24	61.96	58.42	34	87.36	83.82
5	13.70	10.16	15	39.10	35.56	25	64.50	60.96	35	89.90	86.36
6	16.24	12.70	16	41.64	38.10	26	67.04	63.50	36	92.44	88.90
7	18.78	15.24	17	44.18	40.64	27	69.58	66.04	37	94.98	91.44
8	21.32	17.78	18	46.72	43.18	28	72.12	68.58	38	97.52	93.98
9	23.86	20.32	19	49.26	45.72	29	74.66	71.12	39	100.06	96.52
10	26.40	22.86	20	51.80	48.26	30	77.20	73.66	40	102.60	99.06
11	28.94	25.40	21	54.34	50.80	31	79.74	76.20			

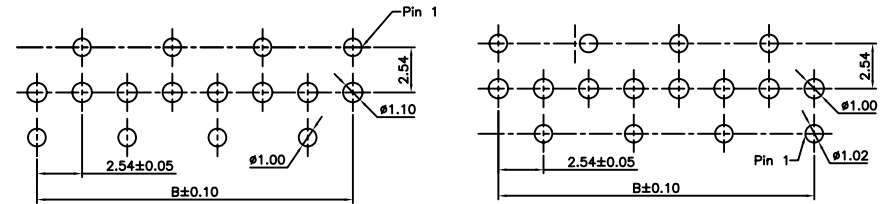

B2 Type

B1 Type

PCB Layout

RoHS Compliant

F				DRAWN:	GENERAL TOLERANCE:		DESCRIPTION: 2.54mm PCB Socket Single Row Bottom Entry Type	SIZE <b>A4</b>
E				Ken	.X = ±0.20 .XX = ±0.15			
D				CHECKED:	UNIT: MM			
C				Lily Chou	SCALE: 1:1			
B				APPROVAL:	SHEET: 1 / 1	PART NO:	PSTB254-XXG-85-BX	
A	09-Mar-2022	(PC0001)	Ken	Chao Peng	PROJECTION:			
REV	DATE	FILE	BY					