

Specifications:  
 Current rating:5.0Amps  
 Voltage rating:250V AC,DC  
 Contact resistance:10mohm Max  
 Insulation resistance:1,000Mohm min.  
 Withstanding voltage:1,500V AC;DC  
 Operating Temperature range:-25°C ~ +105°C  
 Materials:  
 Insulator:High Temp.Plastic(Nylon 46 UL94V-0)  
 Color:Black  
 Contact:Copper Alloy  
 Plating:Gold Plated 15u" on Contact Area,  
 Tin Plated on Solder Tail.

How to order  
 WF1RASM30-XXSG15-TR

- TR:Tape&Reel
- SG15:Selective Gold Plated 15u"
- No.of Positions
- SMD Type
- RA:R/A Single row

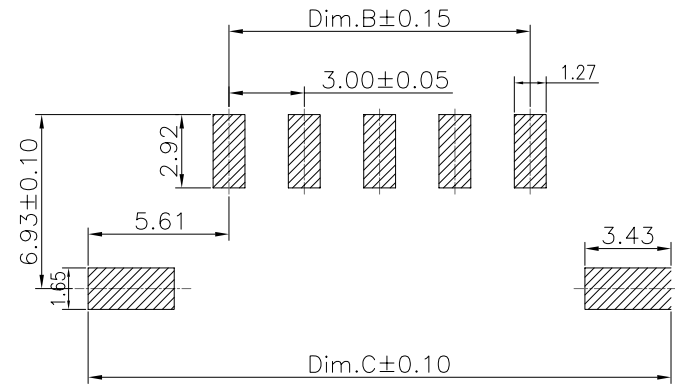

PCB LAYOUT

RoHS Compliant

| Positions | Dimension |       |       | Positions | Dimension |       |       |
|-----------|-----------|-------|-------|-----------|-----------|-------|-------|
|           | A         | B     | C     |           | A         | B     | C     |
| 2         | 9.65      | 3.00  | 14.20 | 8         | 27.65     | 21.00 | 32.20 |
| 3         | 12.65     | 6.00  | 17.20 | 9         | 30.65     | 24.00 | 35.20 |
| 4         | 15.65     | 9.00  | 20.20 | 10        | 33.65     | 27.00 | 38.20 |
| 5         | 18.65     | 12.00 | 23.20 | 11        | 36.65     | 30.00 | 41.20 |
| 6         | 21.65     | 15.00 | 26.20 | 12        | 39.65     | 33.00 | 44.20 |
| 7         | 24.65     | 18.00 | 29.20 |           |           |       |       |

|     |             |          |     |           |           |
|-----|-------------|----------|-----|-----------|-----------|
| F   |             |          |     | DRAWN:    | Ken       |
| E   |             |          |     | CHECKED:  | Lily Chou |
| D   |             |          |     | APPROVAL: | Chao Peng |
| C   |             |          |     |           |           |
| B   |             |          |     |           |           |
| A   | 27-Jun-2018 | (PC0001) | Ken |           |           |
| REV | DATE        | FILE     | BY  |           |           |

|                    |                       |
|--------------------|-----------------------|
| GENERAL TOLERANCE: | .X=±0.20<br>.XX=±0.15 |
| UNIT:              | MM                    |
| SCALE:             | 1:1                   |
| SHEET:             | 1 / 2                 |
| PROJECTION:        |                       |

|              |                                     |
|--------------|-------------------------------------|
|              |                                     |
| DESCRIPTION: | 3.0mm Wafer Single Row R/A SMT Type |
| PART NO:     | WF1RASM30-XXSG15-TR                 |

|      |    |
|------|----|
| SIZE | A4 |
|------|----|