

(4~18 Pin)

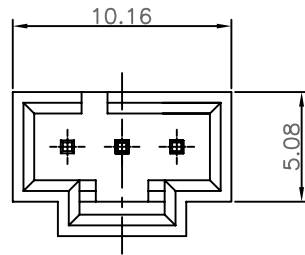

(3 Pin)

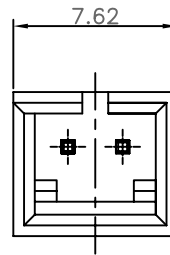

(2 Pin)

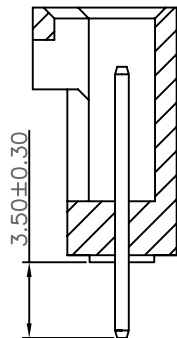
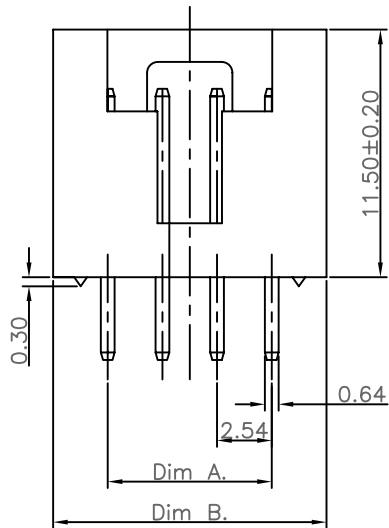

Specifications:
 Current Rating:3.0A AC,DC
 Voltage Rating:250V AC,DC
 Contact Resistance:20mohm Max
 Insulation Resistance:1000Mohm Min.
 Withstanding Voltage:1000V AC/minute
 Operating Temperature Range:-40°C~+105°C
 Material And Finish:

Insulator:PBT (UL94V-0)
 Insulator Color:Black
 Contact:Brass
 Plating:Gold Plated

How To Order
 WF2V254-XXG

G:Gold Plated
 No. Of Positions
 V:Straight Type

Circuits	Dim.A	Dim.B	Circuits	Dim.A	Dim.B
2	2.54	7.62	11	25.40	30.48
3	5.08	10.16	12	27.94	33.02
4	7.62	12.70	13	30.48	35.56
5	10.16	15.24	14	33.02	38.10
6	12.70	17.78	15	35.56	40.64
7	15.24	20.32	16	38.10	43.18
8	17.78	22.86	17	40.64	45.72
9	20.32	25.40	18	43.18	48.26
10	22.86	27.94			

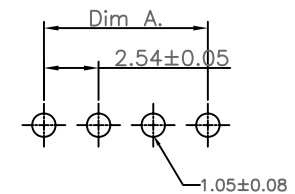

PCB LAYOUT

RoHS Compliant

F				DRAWN: Ken	GENERAL TOLERANCE: .X=±0.20 .XX=±0.15		DESCRIPTION: 2.54mm Pocket Header Straight Single Rowe	SIZE A4
E								
D				CHECKED: Lily Chou	UNIT: MM	PART NO: WF2V254-XXG		
C					SCALE: 1:1			
B				APPROVAL: Chao Peng	SHEET: 1 / 1			
A	12-Oct-2014	(H0050)	Ken		PROJECTION:			
REV	DATE	FILE	BY					