

Lines	Type	A	B	C	Picture
1	WFDR50-04T-2	5	20.3	26.2	
2	WFDR50-06T-2	10	25.3	31.2	
3	WFDR50-08T-2	15	30.3	36.2	
4	WFDR50-10T-2	20	35.3	41.2	
5	WFDR50-14T-2	30	45.3	51.2	
6	WFDR50-18T-2	40	55.3	61.2	
7	WFDR50-22T-2	50	65.3	71.2	

Specifications:  
 Current Rating:20.0A AC/DC  
 Voltage Rating:250V AC/DC  
 Contact Resistance:30m Ohm Max  
 Insulation Resistance:1000M Ohm Min.  
 Withstanding Voltage:1000V AC/Minute  
 Operating Temperature Range:-40°C To +125°C  
 Material and Finish:  
 Insulator:[BT (UL94V-0)]  
 Insulator Color:Black  
 Contact:Brass  
 Plating:Tin Plated  
 How To Order  
 WFDR50-XXT-2

— No.Of Contacts  
 — TR:Double Row R/A Type

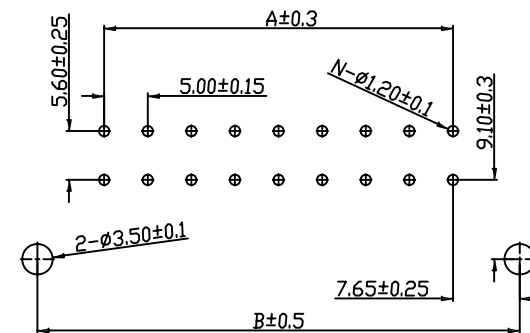

PCB LAYOUT

RoHS Compliant

F			
E			
D			
C			
B			
A	13-Aug-2019	(PC0001)	Ken

DRAWN:  
Ken  
 CHECKED:  
Lily Chou  
 APPROVAL:

GENERAL TOLERANCE:  
 .X=±0.20  
 .XX=±0.15  
 UNIT: MM  
 SCALE: 1:1  
 SHEET: 1 / 1

DESCRIPTION:  
5.0mm Wafer R/A Dip Type  
 PART NO:  
WFDR50-XXT-2

SIZE  
**A4**

