

1

2

3

4

5

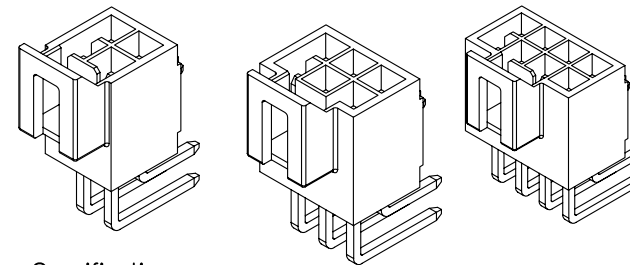
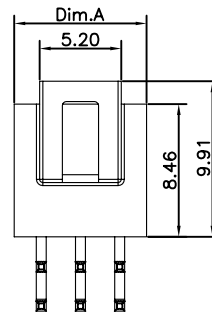
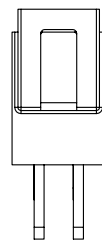
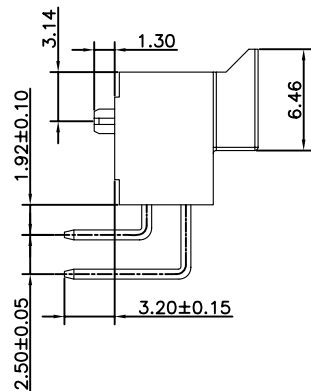
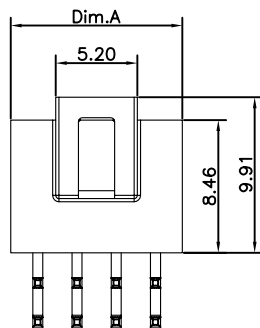

Specifications:  
 Current Rating:6.5A AC,DC  
 Voltage Rating:250V AC,DC  
 Contact Resistance:10mohm Max  
 Insulation Resistance:1000Mohm Min.  
 Withstanding Voltage:1500V AC/minute  
 Operating Temperature Range:-40°C~+105°C  
 Material And Finish:  
 Insulator:High Temp. Plastic(LCP UL94V-0)  
 Insulator Color:Black  
 Contact:Brass  
 Plating:Tin Plated  
 How To Order  
 WFR25-XXX-LK

LK:With Lock  
 G:Gold Plated  
 T:Tin Plated  
 No. Of Positions  
 R:R/A Dip Type

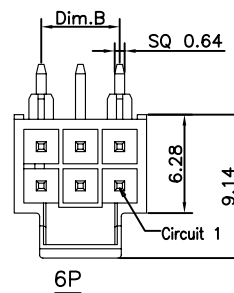
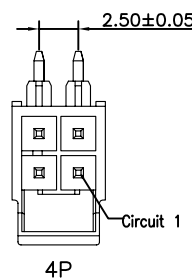
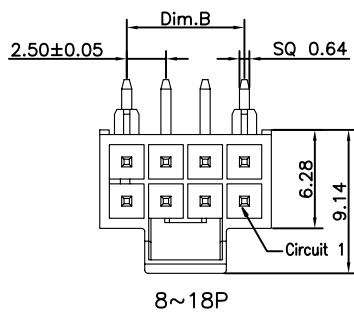

Circuits	Dimension		Circuits	Dimension	
	A	B		A	B
4	5.94	2.50	12	15.94	12.50
6	8.44	5.00	14	18.44	15.00
8	10.94	7.50	16	20.94	17.50
10	13.44	10.00	18	23.44	20.00

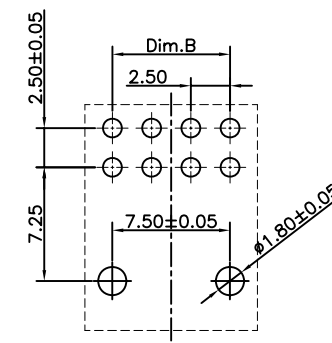
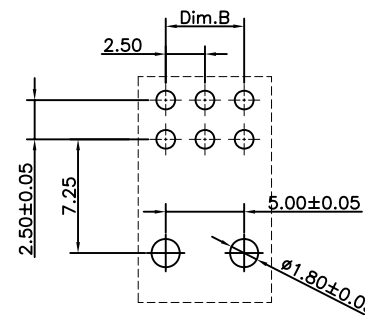
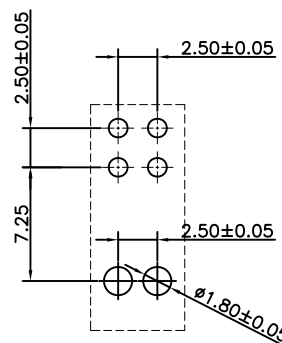

RECOMMENDED PCB LAYOUT

RoHS Compliant

F					
E					
D					
C					
B					
A	05-Mar-2018	(PC0001)	Ken		
REV	DATE	FILE	BY		

DRAWN: Ken	GENERAL TOLERANCE: .X=±0.20 .XX=±0.15
CHECKED: Lily Chou	
APPROVAL: Chao Peng	UNIT: MM SCALE: 1:1 SHEET: 1 / 1 PROJECTION:



DESCRIPTION:  
2.5mm Wafer R/A Double Row Dip With Lock Type

PART NO:  
WFR25-XXX-LK

SIZE  
**A4**