

Specifications:
 Current Rating: 1.0A AC/DC
 Voltage Rating: 50V AC/DC
 Contact Resistance: 40m Ohm. Max.
 Insulation Resistance: 500M Ohm. Min.
 Withstanding Voltage: 500V AC/minute
 Operating Temperature Range: -25°C~+85°C
 Material and Finish:
 Insulatour:High Temp. Plastic (Nylon 6T UL94V-0)
 Insulator Color:Ivory
 Contact:Brass
 Plating:Matte Tin Plated
 How To Order:
 WFRSM15-XX

— No. of Position
 — SMD Type
 — R:Right Angle

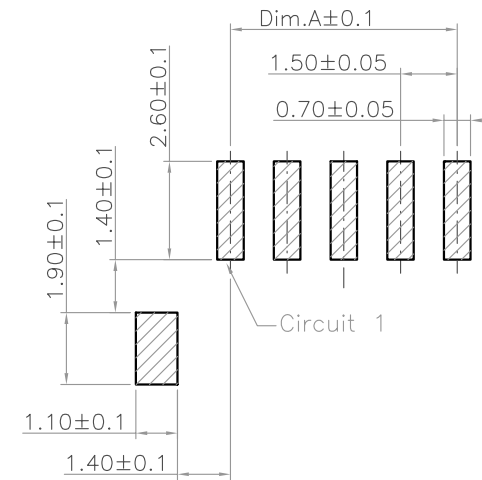
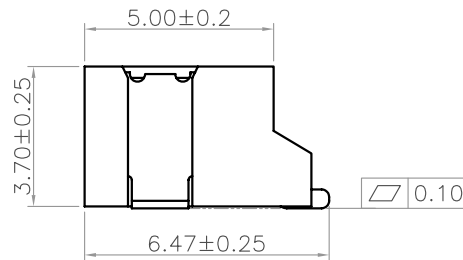
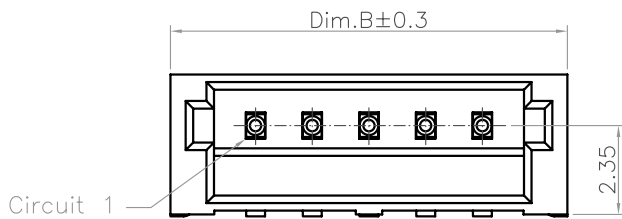

Dimension Information:

Circuits	DIM.A	DIM.B	CIRCUITS	DIM.A	DIM.B	Circuits	DIM.A	DIM.B
2	1.50	6.00	6	7.50	12.00	10	13.50	18.00
3	3.00	7.50	7	9.00	13.50	11	15.00	19.50
4	4.50	9.00	8	10.50	15.00	12	16.50	21.00
5	6.00	10.50	9	12.00	16.50	13	18.00	22.50

Recommended P.C.B Layout

RoHS Compliant

F				DRAWN: Ken	GENERAL TOLERANCE: .X=±0.20 .XX=±0.15	HOYATO 东莞好亚通电子厂	DESCRIPTION: 1.5mm Wafer R/A SMT Type	SIZE A4
E								
D				CHECKED: Lily Chou	UNIT: MM	PART NO: WFRSM15-XX		
C					SCALE: 1:1			
B				APPROVAL: Chao Peng	SHEET: 1 / 1			
A	01-SEP-2013	(PC0001)	Ken		PROJECTION:			
REV	DATE	FILE	BY					