

Specifications:

Current Rating: 3.0A AC, DC
 Voltage Rating: 250V AC, DC
 Contact Resistance: 20mohm Max
 Insulation Resistance: 1000Mohm Min.
 Withstanding Voltage: 1000V AC/minute
 Operating Temperature Range: -40°C ~ +85°C
 Material And Finish:
 Insulator: High Temp. Plastic (Nylon 66 UL94V-0)
 Insulator Color: White
 Contact: Brass
 Plating: Tin Plated

How to Order
 WFVEH-XX-XX

- Blank: White (Standard)
- YL: Yellow; RD: Red; BU: Blue
- No. of Contacts
- Straight Type

Dimension:

Pos	Dim.A	Dim.B	Pos	Dim.A	Dim.B
2	2.50	7.50	8	17.50	22.50
3	5.00	10.00	9	20.00	25.00
4	7.50	12.50	10	22.50	27.50
5	10.00	15.00	11	25.00	30.00
6	12.50	17.50	12	27.50	32.50
7	15.00	20.00			

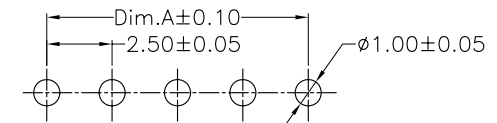

PCB Layout

RoHS Compliant

F				DRAWN:	GENERAL TOLERANCE:		DESCRIPTION:	SIZE	
E				Ken	.X = ±0.20 .XX = ±0.15				
D				CHECKED:	UNIT: MM				2.5mm Wafer Straight Type
C				Lily Chou	SCALE: 1:1				
B				APPROVAL:	SHEET: 1 / 1	PART NO:	A4		
A	01-SEP-2009	(PC0001)	Ken	Chao Peng	PROJECTION:	WFVEH25-XX-XX			
REV	DATE	FILE	BY						