

Specifications:  
 Current Rating:3.0A AC,DC  
 Voltage Rating:250V AC,DC  
 Contact Resistance:20mohm Max  
 Insulation Resistance:1000Mohm Min.  
 Withstanding Voltage:1000V AC/minute  
 Operating Temperature Range:-40°C~+85°C  
 Material And Finish:  
 Insulator:Nylon 66 UL94V-0  
 Insulator Color:White  
 Contact:Brass  
 Plated:Tin Plated  
 How To Order:  
 WFVJ25-XX-XX

WH:White  
 BU:Blue  
 BK:Black  
 YL:Yellow  
 No. Of Contacts  
 VJ:Straight Type

Dimension:

POS.	Dim.A	Dim.B	POS.	Dim.A	Dim.B	POS.	Dim.A	Dim.B
2	2.50	7.50	9	20.00	25.00	16	37.50	42.50
3	5.00	10.00	10	22.50	27.50	17	40.00	45.00
4	7.50	12.50	11	25.00	30.00	18	42.50	47.50
5	10.00	15.00	12	27.50	32.50	19	45.00	50.00
6	12.50	17.50	13	30.00	35.00	20	47.50	52.50
7	15.00	20.00	14	32.50	37.50			
8	17.50	22.50	15	35.00	40.00			

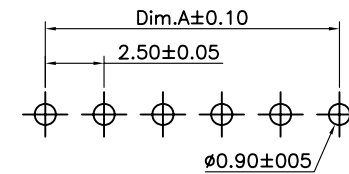

PCB LAYOUT

RoHS Compliant

F				DRAWN:	GENERAL TOLERANCE:		DESCRIPTION:	SIZE	
E			Ken	.X=±0.20 .XX=±0.15	2.5mm Wafer Straight Type				A4
D			CHECKED:	UNIT: MM					
C			Lily Chou	SCALE: 1:1					
B			APPROVAL:	SHEET: 1 / 1	PART NO:	WFVJ25-XX-XX			
A	01-SEP-2009	(PC0001)	Ken	Chao Peng	PROJECTION:				
REV	DATE	FILE	BY						