

1

2

3

4

5

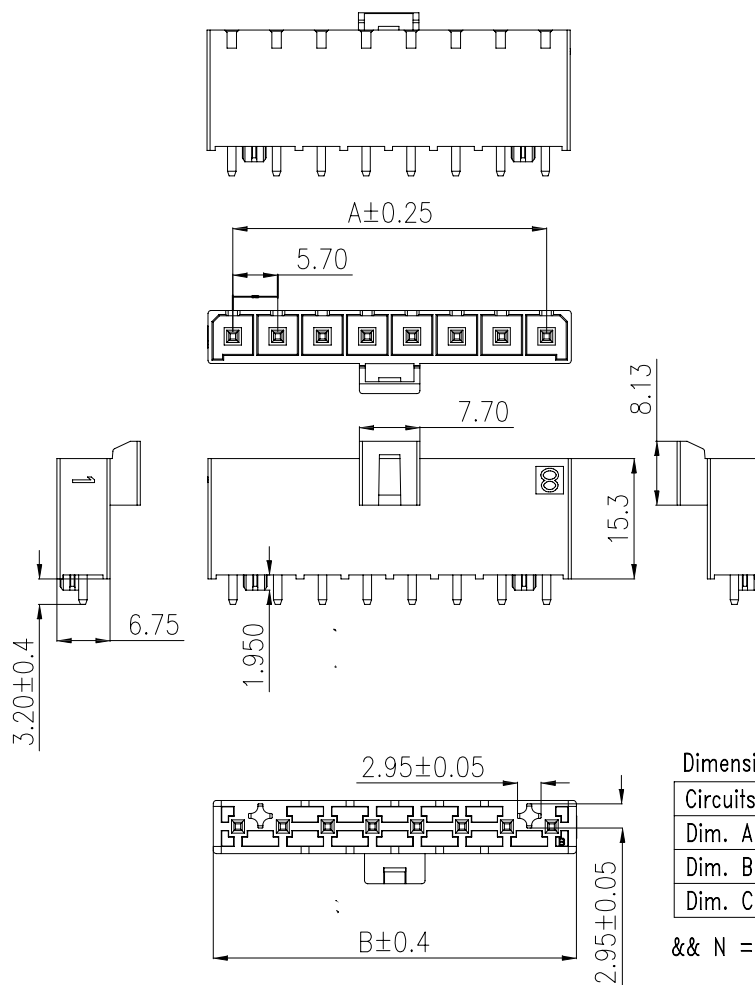

Dimensional Information (mm)

Circuits	2	N
Dim. A	5.70	5.7xN-5.7
Dim. B	12.05	5.7xN+0.65
Dim. C	N/A	5.7x(N-2)

&amp;&amp; N = 4 ~ 12

## Specifications:

Current Rating:23A AC/DC

Voltage Rating:600V AC/DC

Contact Resistance:10m ohm. Max.

Insulation Resistance:1000M ohm. Min.

Withstanding Voltage:2200V AC For One Minute

Operating Temperature Range:-40°C To +105°C

## Materials:

Insulator:High Temp. Plastic(LCP UL94V-0)

Insulator Color:Black

Contact:Brass

Plating:Tin Plated

## How To Order

WFVA57-XXT

— No. Of Contacts  
— VA: Straight Single Row

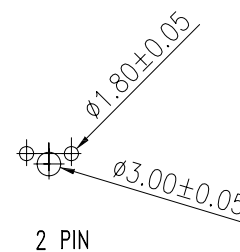

2 PIN

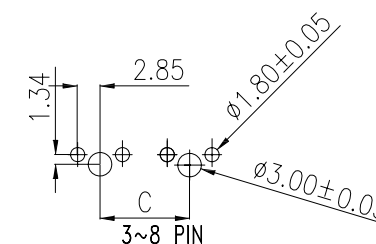

P. C. board layout

RoHS Compliant

F				DRAWN:	GENERAL TOLERANCE:		DESCRIPTION:	SIZE
E				Ken	.X=±0.20 .XX=±0.15			
D				CHECKED:	UNIT: MM	5.7mm Wafer Straight Dip Type	A4	
C				Lily Chou	SCALE: 1:1			
B				APPROVAL:	SHEET: 1 / 1	PART NO:	WFVA57-XXT	
A	07-Mar-2024	(H0001)	Ken	Chao Peng	PROJECTION:			
REV	DATE	FILE	BY					